

Foster™ Back Installation

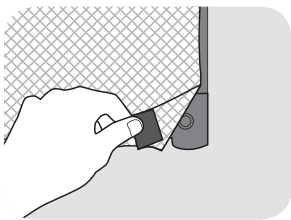

1. Pull back velcro to reveal bolt holes locations on the "Back Assembly."

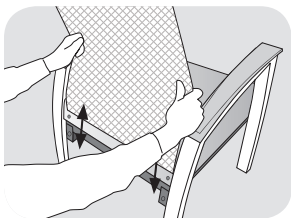

2. Slide the "Back Assembly" into the left and right slots of the chair frame.

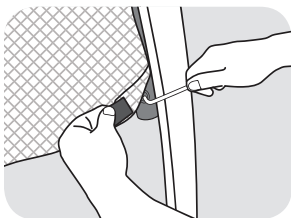

3. Secure with fasteners provided. (1 Bolt per side)

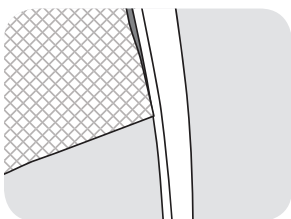

4. Reposition velcro tab.

Foster™ Back Cover Removal

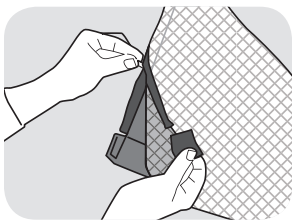

Remove Velcro® or “Hook+Loop”.
Undo Zipper and slide/slip off.

Foster™ Seat Cover Removal

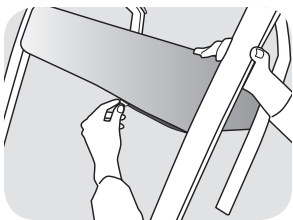

1. Undo Zipper under front of seat.

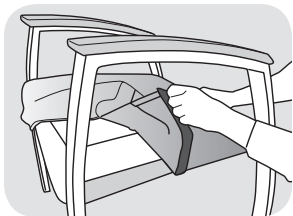

2. Remove velcro under the seat frame along both sides.

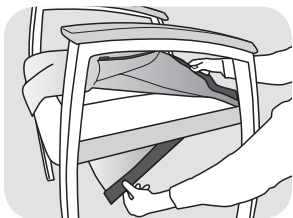

3. Peel velcro from bottom cover under the seat and remove.

Foster™ Seat Cover Replacement

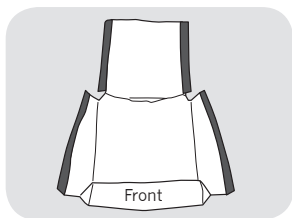

1. Lay the material out flat.

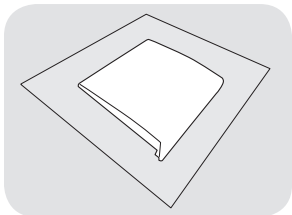

2. Place the foam seat cushion on a flat surface.

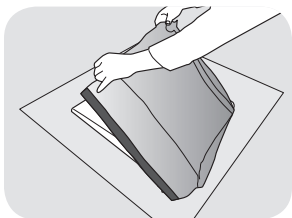

3. Place fabric on the seat foam starting at the front. The Bottom of the cover extends over the rear of the seat cushion.



4. Put the seat in position on the chair and pull the bottom section over and under the seat.

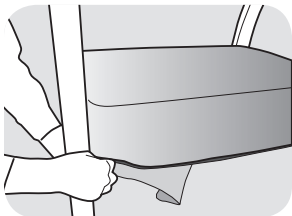

5. Pull the fabric bottom up to the front and attach to "close" the zipper.

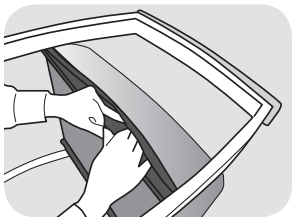

6. Attach the bottom Velcro along the sides.

Foster™ Arm Cap Replacement

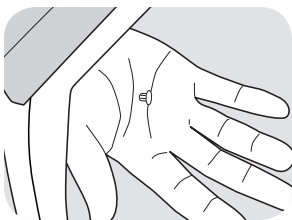

1. Remove the two arm cap access plugs under the arm rest.

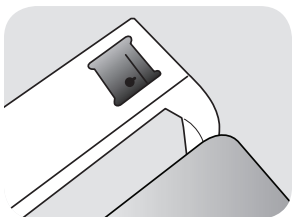

2. Insert a Screwdriver or T-Handle Hex Key (5/32") through the hole and "punch out" the arm cap at the two assembly locations. Small mallet is recommended.

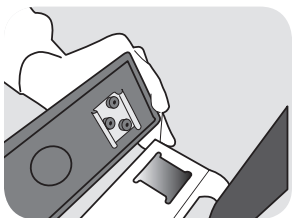

Note: The arm is secured by a metal spring clip as shown.



3. To replace the arm cap, lay in place and strike gently with a rubber mallet at the two fastening locations. Replace access plugs (2 pcs.).

Foster™ Tandem Seat Assembly

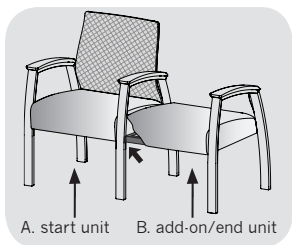

Note: The start unit (left) has assembly holes in the side of the frame to secure the second chair's seat frame. The start unit (left) has holes in the side to secure the second chair to.

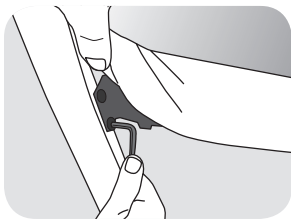

1. Expose assembly area by pushing back the front corner of the seat cushion of chair B to access the bolt/holes. Secure the side of Chair A to Chair B together with fasteners provided.

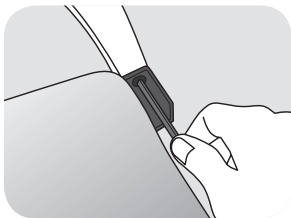

2. Repeat Step 1 at the rear of the chair where another assembly location is located.

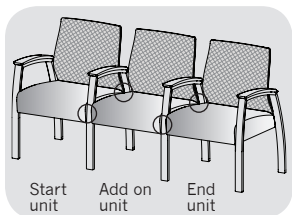

EXAMPLE 1:

This configuration had 4 assembly locations to fasten for completion

Foster™ Tables

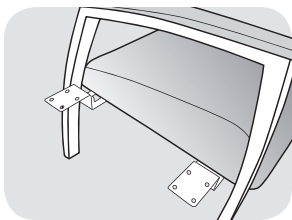

Note 1: Foster Table brackets are delivered installed onto the chair as per specifications from the drawing layout provided.

Note 2: Bracket Holes are always present on chair frames if brackets are ordered separately.

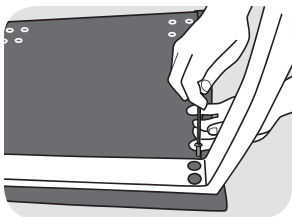

1. Install leg on table with hardware provided.



2. With both brackets installed on chair, place table in position and secure with fasteners provided.

Example 1

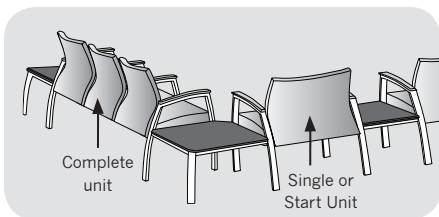

Complete unit

Single or Start Unit

NOTE: Linking tables can only be adjacent to a start units, end units or complete units. Add-on Units do not link to a table.

Example 2

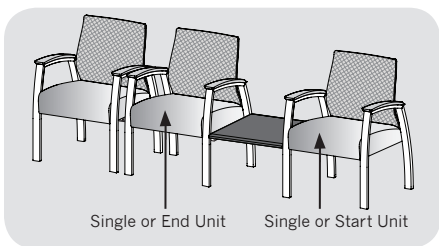

Single or End Unit

Single or Start Unit